

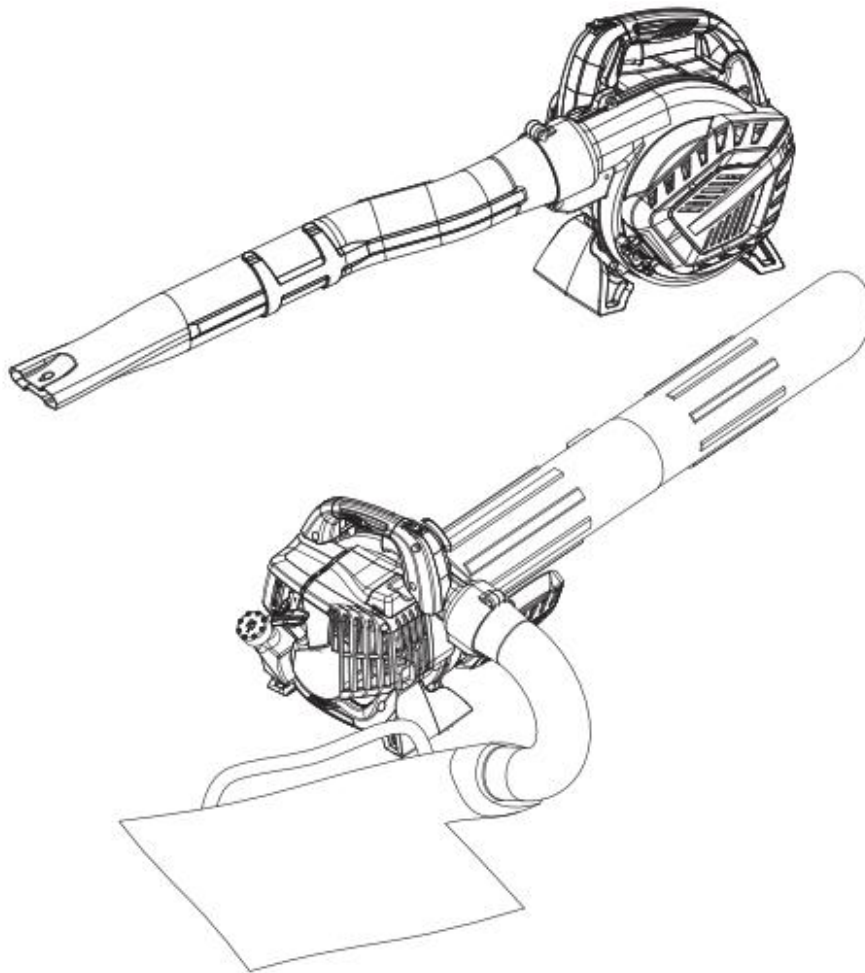

INSTRUCTION MANUAL
PETROL BLOWER VACUUM SHREDDER
RAC26PBL



Read carefully this manual before any use.

BUILDER SAS

32, rue Aristide Bergès –ZI 31270 Cugnaux - France

MADE IN PRC 2020

CONTENTS

1. SAFETY INSTRUCTIONS..... 3

2. YOUR PRODUCT.....7

3. ASSEMBLY.....8

4. FILLING FUEL TANK11

5. OPERATION.....12

6. MAINTENANCE.....14

7. DECLARATION OF CONFORMITY.....16

8. WARRANTY.....17

9. PRODUCT FAILURE.....18

10. WARRANTY EXCLUSIONS.....19

1. SAFETY INSTRUCTIONS

WARNING: For your own safety, please read this manual before attempting to operate your new unit. Failure to follow instructions can result in serious personal injury. Spend a few moments to familiarize yourself with your blower before each use. If you give this tool to another person, also hand over this manual.

Use this tool as described in this manual. Any mishandling and any use contrary to the instructions will not in any way engage the liability of the manufacturer.

Non-compliance with safety instructions and use can cause a risk of electric shock, fire and /or injury to persons.

READ YOUR USER MANUAL THOROUGHLY BEFORE OPERATING YOUR UNIT.

- Never allow children, handicapped or inexperienced people to use the machine. Local regulations may restrict the age of the user.
- Keep children, bystanders and animals away from the machine when using it (at least 15 meters).
- Remember that the user is responsible for accidents or damage to people or their property.
- Never dismantle the machine by yourself. Any disassembly or repair must be carried out by qualified personnel.
- Always wear personal protective equipment (PPE)
- Wear long, thick pants, boots, eye protection and safety gloves. Do not wear loose clothing, shorts or jewellery, and never work barefoot.
- To reduce the risk of injury, never wear loose clothing, scarf, collar, chain, etc. as they could get caught in moving parts. If you have long hair, be sure to tie it above shoulder level to prevent it from getting caught in the moving parts.
- The machine is extremely noisy and requires the use of good quality hearing protection every time you use it.
- Carry the machine only by its handle. Never try to wear it in other places.
- Refuel only in safe places. Open the tank slowly to release any pressure that may have built up in the tank. Clean any gasoline or spills from the machine before using it. To prevent any risk of fire, move at least 10 meters away from the refueling area before starting the machine.
- Switch off the machine before any preparation, installation or maintenance.
- All machine screws should be properly seated and tightened securely. The machine must be in good working order. Never use this machine if it is not assembled correctly.
- Keep handles clean and dry and free from gasoline or oil.
- Always store the machine in a clean and dry place away from all electrical equipment.
- Never start the engine in a closed or poorly ventilated room as the exhaust gases can be fatal.
- Only operate the machine at reasonable times - not too early in the morning or late at night, when people may be disturbed.
- Never use the machine in bad weather or if there is a risk of lightning or thunderstorms. Do not use in the rain or in wet areas.
- Do not use this machine if you are tired, sick, under the influence of alcohol or drugs, or if you are taking medication.
- Do not use this machine in a poorly lit area.

- Keep a safe distance from moving parts and never touch surfaces that become hot during use.
- Wear a mask that filters out microscopic particles if your work generates dust, to avoid the risks associated with inhaling harmful dust.
- Before starting the machine, clear the area where you are going to use it. Remove stones, broken glass, nails, wire ropes, ropes or other objects that could be thrown or get caught in the machine.
- Always keep a good balance. Support yourself well on your legs and do not extend your arm too far. Otherwise, you could fall, slip or injure yourself.
- Let your machine cool down before putting it away.
- Before transporting this machine in a vehicle, empty the fuel tank and secure the machine so that it cannot move during transport.
- To reduce the risk of fire and burns, handle fuel with care. It is an extremely flammable substance.
- Do not smoke when handling fuel.
- Mix and store fuel in a container designed to hold gasoline.
- Mix the fuel in the open air, away from any sparks or flames.
- Choose a clean, bare surface, stop the engine, and allow it to cool before filling it.
- Slowly unscrew the fuel cap to relieve pressure and prevent fuel from spilling around the cap.
- Screw on the tank cap firmly after filling.
- Wipe down the machine if you have spilled fuel.
- Move at least 10m away from where you filled the fuel tank before starting the engine.
- Never attempt to burn spilled fuel.
- When replacing, use only replacement parts and accessories recommended by the manufacturer. Failure to do so could reduce the efficiency of your machine and put you at risk of injury.
- Maintain your machine with care, according to the instructions in the "Care & Cleaning" section of this manual.
- Check the condition of your machine before each use. Make sure that the fasteners are tight, that there are no fuel leaks and that no parts are damaged. Replace any damaged part.
- To reduce the risk of injury from contact with moving parts, stop the engine before installing or removing accessories.
- Do not use your machine if the protective elements are not installed. Always remove the spark plug before carrying out any maintenance or working on any moving part.
- Do not point the blower nozzle at people or pets.
- Never start this machine if the required accessories are not installed.
- Do not operate the machine near open windows,
- Use a rake and broom to loosen debris before blowing.
- Lightly dampen surfaces in dusty conditions before working.
- Use the pipes fully assembled so that the air flow can reach the floor.
- Caution: there is a risk of danger from rotating parts. Avoid coming into contact with them.
- In case of blockage or breakdown, stop using the machine immediately. Inspect it and remove the blockage securely (see chapter "Maintenance". In the event of a fault, please take your machine to a qualified service for inspection.

Maintenance and storage

When the machine is stopped for servicing, inspection, or storage, or to change an accessory, shut off the power source and make sure that all moving parts have come to a complete stop. Allow the machine to cool before making any inspections, adjustments, etc. Maintain the machine with care and keep it clean.

- Store the machine in a dry place out of the reach of children.
- Always allow the machine to cool before storing.
- Replace worn or damaged parts for safety. Use only genuine replacement parts and accessories.
- Never attempt to override the interlocked feature of the guard.

Residuals risks

Even if you use this product in compliance with all safety requirements, potential risks of injury and damage remain. The following hazards may arise from the structure and design of this product. Always be vigilant when using this product, so you can recognize and manage the risks early. Rapid intervention can prevent serious injury and property damage. Turn off the tool if there are any malfunctions. Have it checked by a qualified professional and have repairs carried out, if necessary, before using it again.

- There are harmful health consequences resulting from the emission of vibrations if the product is used for long periods of time or not properly managed and properly maintained.
- There is risk of injury and property damage due to attachments or broken the sudden impact of hidden objects.
- Risk of injury to persons and property caused by flying objects.
- Inhalation of gasoline particles or toxic gases.
- Contact with moving parts. (Ex: Danger related to the starter handle (Risk of kickback))
- Hearing loss if hearing protection is not worn.

Symbols



Read the instructions



Risk of projections! Keep bystanders away



Warning: Wear eye and ear protection



Guarantee noise emission



Do not smoke; do not expose sparks and fire to the tool



Attention, hot surface

Intended use

- This vacuum blower is intended to be used for the vacuuming and the blowing of leaves, dust, and similar little materials. It must not to be used for vacuuming and blowing water, chemical products, flammable material, metal or wood and others dangerous objects.
- This product is intended for private domestic use only. It must be use outdoor.
- This product is not intended to be used in a closed room and places where exhausted gas and flames can be present.
- The use of this product in case of rain or humid environment is prohibited.
- Any other use might lead to damage of the appliance, property or personal injury.

2. YOUR TOOL

a. Description

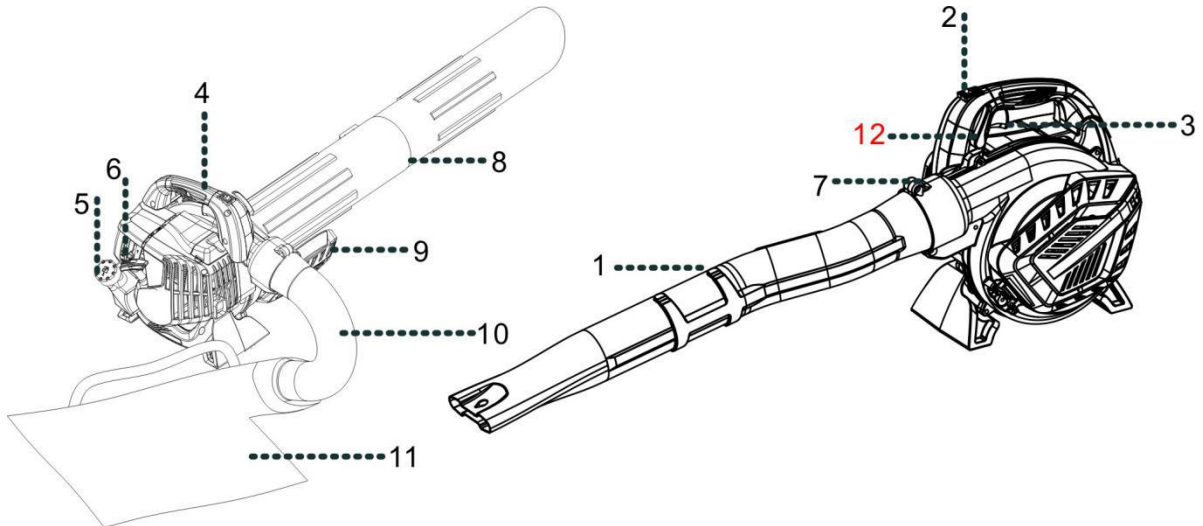

- | | |
|------------------|---------------------------------|
| 1. Blower tube | 7. Tube/collector bag connector |
| 2. ON/OFF switch | 8. Vacuum tube |
| 3. Trigger | 9. Housing of vacuum tube |
| 4. Handle | 10. Collector bag |
| 5. Fuel tank | 11. Collector bag adaptor |
| 6. Starter | 12. throttle control |

b. Technical data

Model	RAC26PBL
Rated power	0.75 kW / 7000min ¹
Idling speed	3000/min
Max speed	7500/min
Weight	5.73kg
Air Speed:	245km/h
Air Volume:	540m ³ /h
Measured sound power level	L _{WA} =106.2, K=3.0dB(A)
Measured sound pressure level	L _{PA} = 94.0dB(A), K=3.0dB(A)
Measured and guarantee sound power level	113dB(A)
Vibration	3.132 m/s ² K=1.5m/s ²

3. ASSEMBLY

For safety reasons, the product is equipped with safety contactors. It will start only when accessories are installed.
It is strictly forbidden to modify safety system installed by the manufacturer.



WARNING! You cannot use both functions simultaneously.

A. BLOWER MODE

-Assemble the two blowing tubes together. Twist tube B to lock it in place.

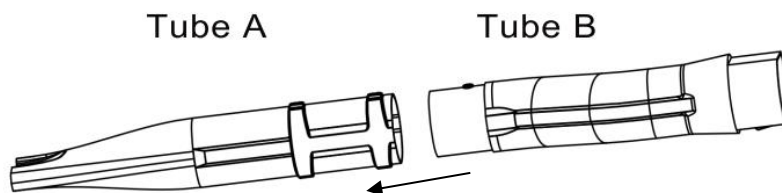

-Place the blowing tubes on the machine.

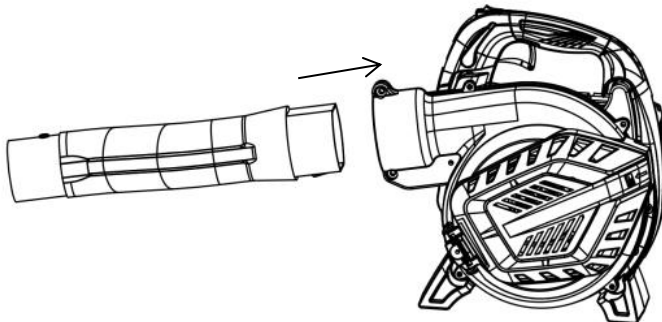

-Tighten the two screws to secure the tubes to the machine.

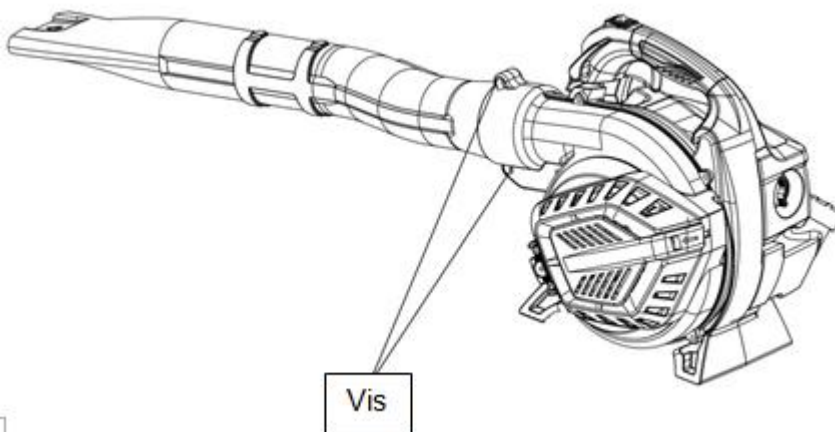

1

B. VACUUM MODE

-Assemble the two suction tubes together. Open the cover on the side of the machine. Insert the suction tube and twist it slightly to lock it.

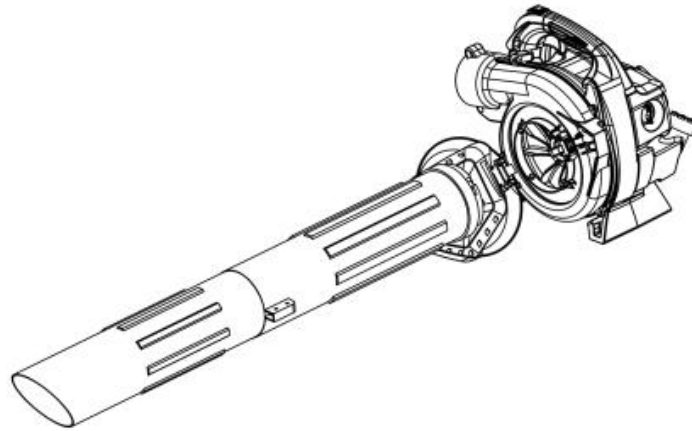

-Open the collection bag and insert the adapter into it. Bring out the smaller part through the hole at the end of the bag. Then close the bag.

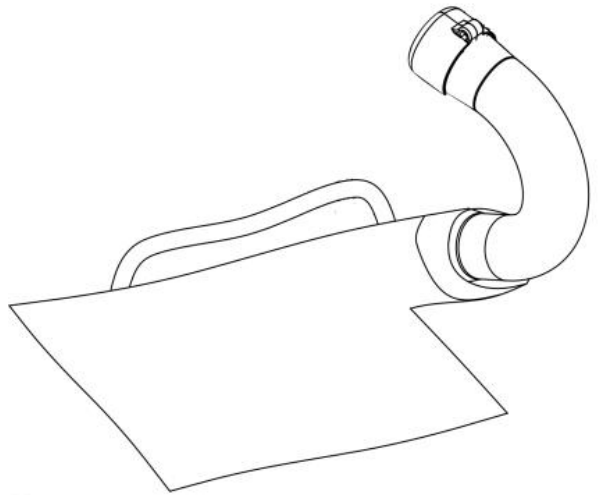

-Install the collection bag in the machine by inserting the end of the adapter into the connection hole of the collection bag. Tighten the screws to secure the installation.

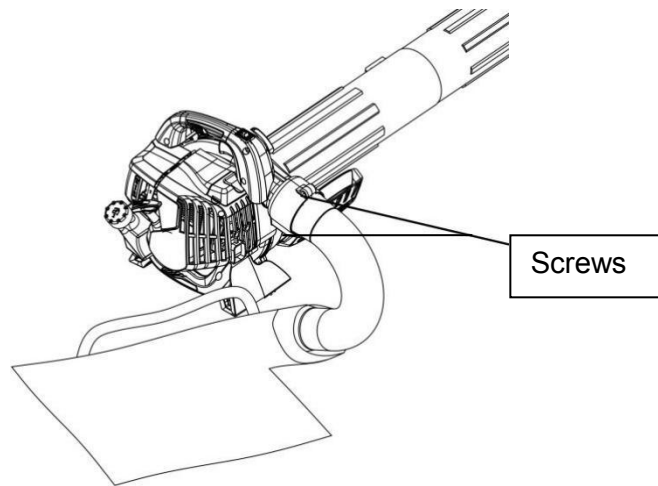

To detach the collection bag, turn off the machine first, if it is on. Open the bag and empty it. Then unscrew the two security screws and remove the adapter.

4. FILLING FUEL TANK

MOTOR FUEL: mix the petrol and oil at 40:1 only

- Use fresh unleaded petrol. You must use 100% synthetic oil specifically made for heavily stressed two stroke engines.
- Mix the petrol and oil in an approved container. Never mix fuel directly in the line trimmer fuel tank.
- Place the brush cutter upright on the ground or on a sturdy bench and wipe any debris from around the fuel cap.
- Unscrew the fuel tank cap and pour the mixture into the tank with the aid of a funnel.
- Be careful not to spill any mixture. If this happens, wipe the spill with a clean rag.
- Start the engine at least three metres away from the area where the fuel tank has been filled up in order to avoid any risk of fire.

Danger of fire and burn injuries

- Always use extreme care when handling fuel! Fuel is highly flammable.
- Never attempt to fuel the line trimmer if the fuel system components are damaged or are leaking.
- Never attempt to refuel the engine while it is running or still warm, allow it to cool before fuelling.
- Never smoke or light any fires near the line trimmer or fuels.
- Always transport and store fuels in an approved container.
- Never place flammable material close to the engine muffler.
- Never operate the line trimmer without a properly functioning muffler and spark arrestor installed.
- Never operate the line trimmer unless it is properly assembled and in good working condition.
- Do not use petrol which contains ethanol or methanol as it may damage the fuel lines and other engine parts.
- Mix only enough fuel for your immediate needs. If fuel must be stored longer than 30 days, it should first be treated with a stabilizer or similar product.

5. OPERATION

a. Before starting

- Be sure that you have correctly completed the installation.
- Inspect the work area. Make sure there are no obstacles or dangerous debris that could damage the tool.

b. Start/stop the machine

NOTE: Starting the product differs depending on whether the engine is cold or warm.

1. Move the ON/OFF switch to the ON position (I).



2. Move the throttle control to the idle position

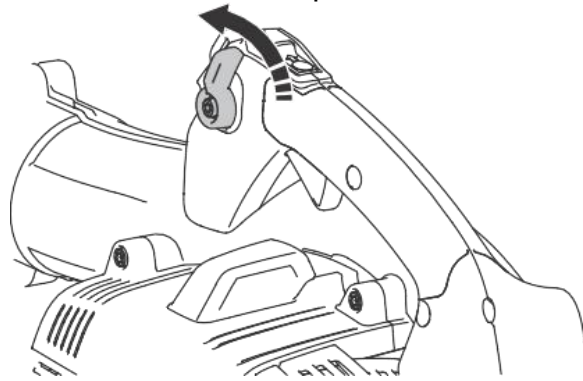

3. Move the choke lever upwards to the start position (cold start).

Note. This is not required if the engine is already warm.

4. Push the primer button 8 times, until the petrol/oil mixture flows in and out of the discharge hose located above the fuel tank.
5. Pull the recoil starter 2-3 times until you hear the engine starting.

6. Push the choke lever down to the run position (warm start).
7. The engine may start, or it may be required to pull on the recoil starter until the engine starts.
8. Allow the engine to run idle for around 10 seconds to let it warm up.
9. Pull the trigger to start the operation.
10. You can set the throttle control position to lock the trigger in the operating position. To unlock the trigger, pull the throttle control or push the trigger.

To stop:

1. Release the throttle trigger and allow the engine to idle for a few moments.
2. Move the ON/OFF switch to the OFF position (O).
3. The engine will now stop.

c. Blower mode

- Inspect the work area before starting. Remove any debris or objects that could be thrown or those that can get caught or obstruct the device.
- Put the shoulder strap.
- Hold the machine by the handle. Walk and hold the tube just above the ground and blow the debris.
- Work in order to gather the debris in one or more lots. Use the vacuum mode to collect the heap. You can also pick up the pile of debris with a broom (or rake) and a shovel.
- Throw away the debris in a trash bin.

d. Vacuum mode

IMPORTANT!

Do not vacuum wet debris (they must be dry), nor large and hard objects that may damage the machine (stones, cans, pieces of wood too large, etc.).

Do not vacuum flammable objects, and objects on fire.

The collection bag must always be set during suction.

- Inspect the work area before starting. Remove any debris or objects that could be thrown or those that can get caught or obstruct the device.
- Put the shoulder strap.
- Hold the handle of the tool and the tube to raise and maintain the machine.
- Put the tube to the ground without putting it in the debris. Move while sucking debris.

When the collection bag is filled, stop working and empty the bag.

6. MAINTENANCE

Follow these instructions to keep your machine in a good condition. A machine cleaned and in a good condition will give better operating results and preserves the life of the device. Regularly maintain your machine.



WARNING! Do not use products that can damage the device (abrasive, corrosive, alcohols, steam cleaners, abrasive cloths, scrapers, etc.). Do not install the appliance in a dishwasher for cleaning! The unit must be completely switched off, unplugged, and cool before cleaning.

a. Care

After each use:

- Remove the collection bag and empty its contents into a dustbin.
- Use a brush to remove debris from fan and inside the tube.
- If necessary, you can clean the body of the tool with a soft dry cloth.
- Keep the cylinder fins free from dust or dirt. Dust or dirt adhering to the fins can cause the motor to overheat.
- The blown air is drawn in through the air inlet vent. When the airflow drops during operation, stop the engine and inspect the air inlet vent for any blockage. Clean it if necessary. Such a blockage can cause overheating and damage the motor.
- Check all nuts, bolts and screws are tight and that the safety devices are properly positioned.
- Check if the machine has not suffered damage. If the machine is damaged, you will need to hire a qualified technician to inspect the machine and makes repairs.

WARNING

Use only original manufacture's replacement parts, accessories and attachment. Failure to do so can cause possible injury, poor performance.

b. Replacing and cleaning the air filter

- Unscrew the air filter cover and remove it.
- Remove the air filter and clean it in warm soapy water. Let dry completely. For best performance, replace the air filter annually.
- Reinstall the air filter into the filter base.
- Push the cover back in place.
- Replace the cover and screw it on.

c. Checking the spark plug

- Check the spark plug every 10-15 hours of use.
- Remove the spark plug cover.
- Use the spark plug wrench to remove the spark plug, by turning it counter-clockwise.
- Clean and adjust the spark plug gap to 0.6 - 0.7mm.
- Replace any damaged or visibly worn plug with a TORCH L8RTC or equivalent spark plug.
- Install the spark plug finger tight in the cylinder head, and then tighten it firmly with the spark plug wrench.

d. Other maintenances and works

Any maintenance and adjustment work that is not included and described in this manual should only be performed by an authorized service agent.

7. DECLARATION OF CONFORMITY



BUILDER SAS

ZI, 32 rue Aristide Bergès – 31270 Cugnaux - France

Tel: +33 (0)5.34.502.502 Fax: +33 (0)5.34.502.503

Declares that the machines:
PETROL BLOWER & VACUUM
Model: RAC26PBL
Serial No.: [20200713823-20200713892](#)

The people name holding the technical file: M. Olivier Patriarca

Have been designed in compliance with the following standards:

EN 15503:2009+A2:2015

EN ISO 14982:2009

EN ISO 3744:1995 & ISO 11094:1991

And in accordance with the following directives:

Directive Machine 2006/42/EC

Directive EMC 2014/30/EU

Noise Directive 2000/14/EC ANNEX V & Directive 2005/88/EC

Emission directive 97/68/EC & 2012/46/EU

Measured sound power level: 106.2 dB(A) K=3.0dB(A)

Guaranteed sound power level: 113 dB(A)

Cugnaux, 18/07/2020

Philippe MARIE / PDG

9. WARRANTY



WARRANTY

The manufacturer guarantees the product against defects in material and workmanship for a period of 2 years from the date of the original purchase. The warranty only applies if the product is for household use. The warranty does not cover breakdowns due to normal wear and tear.

The manufacturer agrees to replace parts identified as defective by the designated distributor. The manufacturer does not accept responsibility for the replacement of the machine, in whole or in part, and/or ensuing damage.

The warranty does not cover breakdowns due to:

- insufficient maintenance.
- abnormal assembly, adjustment or operations of the product.
- parts subject to normal wear and tear.

The warranty does not extend to:

- shipping and packaging costs.
- using the tool for a purpose other than that for which it was designed.
- the use and maintenance of the machine done in a manner not described in the user manual.

Due to our policy of continuous product improvement, we reserve the right to alter or change specifications without notice. Consequently, the product may be different from the information contained therein, but a modification will be undertaken without notice if it is recognized as an improvement of the preceding characteristic.

READ THE MANUAL CAREFULLY BEFORE USING THE MACHINE.

When ordering spare parts, please indicate the part number or code, you can find this in the spare parts list in this manual. Keep the purchase receipt; without it, the warranty is invalid. To help you with your product, we invite you to contact us by phone or via our website:

- **+33 (0)9.70.75.30.30**
- **<https://services.swap-europe.com/contact>**

You must create a "ticket" via the web platform.

- Register or create your account.
- Indicate the reference of the tool.
- Choose the subject of your request.
- Describe your problem.
- Attach these files: invoice or sales receipt, photo of the identification plate (serial number), photo of the part you need (for example: pins on the transformer plug which are broken).



9. PRODUCT FAILURE

WHAT TO DO IF MY MACHINE BREAKS DOWN?

If you bought your product in a store:

- a) Empty the fuel tank.
- b) Make sure that your machine is complete with all accessories supplied, and clean! If this is not the case, the repairer will refuse the machine.

Go to the store with the complete machine and with the receipt or invoice.

If you bought your product on a website:

- a) Empty the fuel tank.
- b) Make sure that your machine is complete with all accessories supplied, and clean! If this is not the case, the repairer will refuse the machine.
- c) Create a SWAP-Europe service ticket on the site: <https://services.swap-europe.com> When making the request on SWAP-Europe, you must attach the invoice and the photo of the nameplate (serial number).
- d) Contact the repair station to make sure it is available before dropping off the machine.

Go to the repair station with the complete machine packed, accompanied by the purchase invoice and the station support sheet downloadable after the service request is completed on the SWAP-Europe site

For machines with engine failure from manufacturers BRIGGS & STRATTON, HONDA and RATO, please refer to the following instructions.

Repairs will be done by approved engine manufacturers of these manufacturers, see their site:

- <http://www.briggsandstratton.com/eu/fr>
- <http://www.honda-engines-eu.com/fr/service-network-page;jsessionid=5EE8456CF39CD572AA2AEEDFD290CDAE>
- <https://www.rato-europe.com/it/service-network>

Please keep your original packaging to allow for after-sales service returns or pack your machine with a similar cardboard box of the same dimensions.

For any question concerning our after-sales service you can make a request on our website <https://services.swap-europe.com>

Our hotline remains available at +33 (9) 70 75 30 30.



10. WARRANTY EXCLUSIONS

THE WARRANTY DOES NOT COVER:

- Start-up and setting up of the product.
- Damage resulting from normal wear and tear of the product.
- Damage resulting from improper use of the product.
- Damage resulting from assembly or start-up not in accordance with the user manual.
- Breakdowns related to carburetion beyond 90 days and fouling of carburetors.
- Periodic and standard maintenance events.
- Actions of modification and dismantling that directly void the warranty.
- Products whose original authentication marking (brand, serial number) has been degraded, altered or withdrawn.
- Replacement of consumables.
- The use of non-original parts.
- Breakage of parts following impacts or projections.
- Accessories breakdowns.
- Defects and their consequences linked to any external cause.
- Loss of components and loss due to insufficient screwing.
- Cutting components and any damage related to the loosening of parts.
- Overload or overheating.
- Poor power supply quality: faulty voltage, voltage error, etc.
- Damages resulting from the deprivation of enjoyment of the product during the time necessary for repairs and more generally the costs related to the immobilization of the product.
- The costs of a second opinion established by a third party following an estimate by a SWAP-Europe repair station
- The use of a product which would show a defect or a breakage which was not the subject of an immediate report and/or repair with the services of SWAP-Europe.
- Deterioration linked to transport and storage*.
- Launchers beyond 90 days.
- Oil, petrol, grease.
- Damages related to the use of non-compliant fuels or lubricants.

* In accordance with transport legislation, damage related to transport must be declared to carriers within 48 hours maximum after observation by registered letter with acknowledgement of receipt.

This document is a supplement to your notice, a non-exhaustive list.

Attention: all orders must be checked in the presence of the delivery person. In case of refusal by the delivery person, it you must simply refuse the delivery and notify your refusal.

Reminder: the reserves do not exclude the notification by registered letter with acknowledgement within 72 hours.

Information:

Thermal devices must be wintered each season (service available on the SWAP-Europe site). Batteries must be charged before being stored.